

# Tru-Bore® Pressed Tees

Tru-Bore® pressed tees are a type of fitting that is used to form a branch off a piping system. It has a permanent press joint.

Tru-Bore® pressed tees are always equal. An equal tee means that the branch diameter is same as the main run pipe.

Typically, the stainless steel Tru-Bore® pressed tees that Special Metric Materials supplies are manufactured to EN 10253-4/EN 10253-3. Tru-Bore® pressed tees manufactured to EN 10253-4 have a weld factor of  $z=1$  & are rated to a higher pressure capability.

Special Metric Materials can supply Tru-Bore® pressed tees in the following Grades: 304L (1.4307), 316L (1.4404) & 316L High Moly (1.4432).

*Tru-Bore® is a registered trademark of OSTP.*

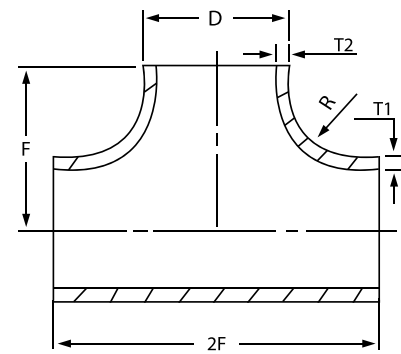

DN	D	F	2F	R	T1/T2 2.0/1.8	T1=T2 2.0	T1=T2 2.5	T1=T2 3.0	T1=T2 4.0
15	20	25	50	9.5	0.08				
20	25	30	60	9.5	0.1				
25	30	35	70	14	0.14				
32	38	43	86	18	0.22				
40	44.5	50	100	15	0.32				
50	54	61	122	17	0.48				
65	69	73	146	25	0.79				
65*	76	80	160	30.5				1.1	
65*	79	80	160	32	0.75				
80*	84	80	160	30		0.8	1	1.2	
100*	104	90	180	25		1.3			
	105/106						1.8	2.16	
125*	129	115	230	40		2.1			
	130/131						2.8	3.36	
150*	154	135	270	40		3.1			
	155/156						4	4.8	
200*	205	175	350	57			6.1		
	206							8.2	
250	256	216	432	75				10	
	258								13
300	306	254	508	80				13	
	308								19
356	356	279	558	72				18	
	358								23
400	406	305	610	90				28	
	408								28
	410								
450	456	343	686	100				36	
	458								36
	460								
500	506	381	762	105				44	
	508								44
	510								
600	606	432	864	110				72	
	508								72
	610								