

ANSI PLATE FLANGES

Special Metric Materials stocks ANSI plate flanges. A plate flange is a flat disc that can be welded or fixed to a pipe's end that allows it to be bolted to another pipe. Sometimes, two plate flanges are bolted together with a gasket in the middle. ANSI plate flanges are often used in water and chemical, steam and condensate pipelines.

Special Metric Materials stocks ANSI plate flanges in accordance with EN1092-1.

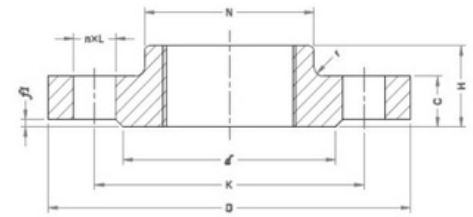

ANSI plate flanges are available in a range of sizes, including custom fittings that can be manufactured to order.

Special Metric Materials has ANSI plate flanges readily available in stainless steel 304 and 316. Both welded and seamless fittings are available.

DN	Pipe OD, A		Outside Diameter, D	Diameter of Bolt Circle, K	Diameter of Bolt Hole, L	No. of Bolt	Size of Bolt	Flange Thickness, C	Diameter of Raised Face, d	Height of Raised Face, f1	Bore diameter, B	
	Series I	Series II									Series I	Series II
PN10												
10	17.2	14	90	60	14	4	M12	14	40	2	18	15
15	21.3	18	95	65	14	4	M12	14	45	2	22	19
20	26.9	25	105	75	14	4	M12	16	58	2	27.5	26
25	33.7	32	115	85	14	4	M12	16	68	2	34.5	33
32	42.4	38	140	100	18	4	M16	18	78	2	43.5	39
40	48.3	45	150	110	18	4	M16	18	88	3	49.5	46
50	60.3	57	165	125	18	4	M16	20	102	3	61.5	59
65	76.1	79	185	145	18	8	M16	20	122	3	77.5	78
80	88.9	89	200	160	18	8	M16	20	138	3	90.5	91
100	114.3	108	220	180	18	8	M16	22	158	3	116	110
125	139.7	133	250	210	18	8	M16	22	188	3	141.5	135
150	168.3	159	285	240	22	8	M20	24	212	3	170.5	161
200	219.1	219	340	295	22	8	M20	24	268	3	221.5	222
250	273	273	395	350	22	12	M20	26	320	3	276.5	276
300	323.9	325	445	400	22	12	M20	26	370	4	327.5	328
350	355.6	377	505	460	22	16	M20	30	430	4	359.5	380
400	406.4	426	565	515	26	16	M24	32	482	4	411	430
450	457	480	615	565	26	20	M24	36	532	4	462	484
500	508	530	670	620	26	20	M24	38	585	4	513.5	534
600	610	630	780	725	30	20	M27	42	685	5	616.5	634
700	711	720	895	840	30	24	M27	50	800	5	715	724
800	813	820	1015	950	33	24	M30	56	905	5	817	824
900	914	920	1115	1050	33	28	M30	62	1005	5	918	924
1000	1016	1020	1230	1160	36	28	M33	70	1110	5	1020	1024
1200	1219	1220	1455	1380	39	32	M36	83	1330	5	1223	1224
1400	1422	1420	1675	1590	42	36	M39	90	1535	5	1426	1424
1600	1626	1620	1915	1820	48	40	M45	100	1760	5	1630	1624
1800	1829	1820	2115	2020	48	44	M45	110	1960	5	1833	1824
2000	2032	2020	2325	2230	48	48	M45	120	2170	5	2036	2024



ANSI PLATE FLANGES

DN	Pipe OD, A		Outside Diameter, D	Diameter of Bolt Circle, K	Diameter of Bolt Hole, L	No. of Bolt	Size of Bolt	Flange Thickness, C	Diameter of Raised Face, d	Height of Raised Face, f1	Bore diameter, B	
	Series I	Series II									Series I	Series II
PN16												
10	17.2	14	90	60	14	4	M12	14	40	2	18	15
15	21.3	18	95	65	14	4	M12	14	45	2	22	19
20	26.9	25	105	75	14	4	M12	16	58	2	27.5	26
25	33.7	32	115	85	14	4	M12	16	68	2	34.5	33
32	42.4	38	140	100	18	4	M16	18	78	2	43.5	39
40	48.3	45	150	110	18	4	M16	18	88	3	49.5	46
50	60.3	57	165	125	18	4	M16	20	102	3	61.5	59
65	76.1	79	185	145	18	8	M16	20	122	3	77.5	78
80	88.9	89	200	160	18	8	M16	20	138	3	90.5	91
100	114.3	108	220	180	18	8	M16	22	158	3	116	110
125	139.7	133	250	210	18	8	M16	22	188	3	141.5	135
150	168.3	159	285	240	22	8	M20	24	212	3	170.5	161
200	219.1	219	340	295	22	12	M20	26	268	3	221.5	222
250	273	273	405	355	26	12	M24	29	320	3	276.5	276
300	323.9	325	460	410	26	12	M24	32	378	4	327.5	328
350	355.6	377	520	470	26	16	M24	35	438	4	359.5	380
400	406.4	426	580	525	30	16	M27	38	490	4	411	430
450	457	480	640	585	30	20	M27	42	550	4	462	484
500	508	530	715	650	33	20	M30	46	610	4	513.5	534
600	610	630	840	770	36	20	M33	55	725	5	616.5	634
700	711	720	910	840	36	24	M33	63	795	5	715	724
800	813	820	1025	950	39	24	M36	74	900	5	817	824
900	914	920	1125	1050	39	28	M36	82	1000	5	918	924
1000	1016	1020	1255	1170	42	28	M39	90	1115	5	1020	1024
1200	1219	1220	1485	1390	48	32	M45	95	1330	5	1223	1224
1400	1422	1420	1685	1590	48	36	M45	103	1530	5	1426	1424
1600	1626	1620	1930	1820	56	40	M52	115	1750	5	1630	1624
1800	1829	1820	2130	2020	56	44	M52	126	1950	5	1833	1824
2000	2032	2020	2345	2230	62	48	M56	138	2150	5	2036	2024
PN25												
10	17.2	14	90	60	14	4	M12	14	40	2	18	15
15	21.3	18	95	65	14	4	M12	14	45	2	22	19
20	26.9	25	105	75	14	4	M12	16	58	2	27.5	26
25	33.7	32	115	85	14	4	M12	16	68	2	34.5	33
32	42.4	38	140	100	18	4	M16	18	78	2	43.5	39
40	48.3	45	150	110	18	4	M16	18	88	3	49.5	46
50	60.3	57	165	125	18	4	M16	20	102	3	61.5	59
65	76.1	79	185	145	18	8	M16	22	122	3	77.5	78
80	88.9	89	200	160	18	8	M16	24	138	3	90.5	91
100	114.3	108	235	190	22	8	M20	26	162	3	116	110
125	139.7	133	270	220	26	8	M24	28	188	3	141.5	135
150	168.3	159	300	250	26	8	M24	30	218	3	170.5	161
200	219.1	219	360	310	26	12	M24	32	278	3	221.5	222
250	273	273	435	370	30	12	M27	35	335	3	276.5	276
300	323.9	325	485	430	30	16	M27	38	395	4	327.5	328
350	355.6	377	555	490	33	16	M30	42	450	4	359.5	380
400	406.4	426	620	550	36	16	M33	48	505	4	411	430
450	457	480	670	600	36	20	M33	54	555	4	462	484
500	508	530	730	660	36	20	M33	58	615	4	513.5	534
600	610	630	845	770	39	20	M36	68	720	5	616.5	634
700	711	720	960	875	42	24	M39	85	820	5	715	724
800	813	820	1085	990	48	24	M45	95	930	5	817	824



ANSI PLATE FLANGES

DN	Pipe OD, A		Outside Diameter, D	Diameter of Bolt Circle, K	Diameter of Bolt Hole, L	No. of Bolt	Size of Bolt	Flange Thickness, C	Diameter of Raised Face, d	Height of Raised Face, f1	Bore diameter, B	
	Series I	Series II									Series I	Series II
PN40												
10	17.2	14	90	60	14	4	M12	14	40	2	18	15
15	21.3	18	95	65	14	4	M12	14	45	2	22	19
20	26.9	25	105	75	14	4	M12	16	58	2	27.5	26
25	33.7	32	115	85	14	4	M12	16	68	2	34.5	33
32	42.4	38	140	100	18	4	M16	18	78	2	43.5	39
40	48.3	45	150	110	18	4	M16	18	88	3	49.5	46
50	60.3	57	165	125	18	4	M16	20	102	3	61.5	59
65	76.1	79	185	145	18	8	M16	22	122	3	77.5	78
80	88.9	89	200	160	18	8	M16	24	138	3	90.5	91
100	114.3	108	235	190	22	8	M20	26	162	3	116	110
125	139.7	133	270	220	26	8	M24	28	188	3	141.5	135
150	168.3	159	300	250	26	8	M24	30	218	3	170.5	161
200	219.1	219	375	320	30	12	M27	36	285	3	221.5	222
250	273	273	450	385	33	12	M30	42	345	3	276.5	276
300	323.9	325	515	450	33	16	M30	52	410	4	327.5	328
350	355.6	377	580	510	36	16	M33	58	465	4	359.5	380
400	406.4	426	660	585	39	16	M36	65	535	4	411	430
450	457	480	685	610	39	20	M36	66	560	4	462	484
500	508	530	755	670	42	20	M39	72	615	4	513.5	534
600	610	630	890	795	48	20	M45	84	735	5	616.5	634

