

ANSI THREADED FLANGES

Special Metric Materials stocks ANSI threaded flanges. ANSI threaded flanges can also be known as 'companion flanges,' 'screw flanges' or 'NPT flanges'. Threaded flanges use screw threads to connect the flange to the pipe, with the male thread on the pipe end and the female thread cut into the bore of the flange. The two ends can then be screwed together.

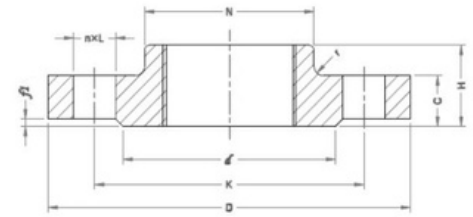

Special Metric Materials stocks ANSI threaded flanges in accordance with EN1092-1.

ANSI threaded flanges are available in a range of sizes, including custom fittings that can be manufactured to order.

Special Metric Materials has ANSI threaded flanges readily available in stainless steel 304 and 316. Both welded and seamless fittings are available.

Nominal Pipe Size	Outside Diameter mm	Overall Diameter mm	Flange Thickness Min	Face Diameter mm	Number of Holes	Bolt Hole Diameter	Diameter of Circle Holes	Weight Kg/piece
1/2	0.84	3.5	0.44	1.38	4	0.62	2.38	0.42
	21.3	88.9	11.2	35.1				
3/4	1.05	3.88	0.5	1.69	4	0.62	2.75	0.61
	26.7	98.6	12.7	42.9				
1	1.315	4.25	0.56	2	4	0.62	3.12	0.86
	33.4	108	14.2	50.8				
1 1/4	1.66	4.62	0.62	2.5	4	0.62	3.5	1.17
	42.2	117.3	15.7	63.5				
1 1/2	1.9	5	0.69	2.88	4	0.62	3.88	1.53
	48.3	127	17.5	73.15				
2	2.375	6	0.75	3.62	4	0.75	4.75	2.42
	60.3	152.4	19.1	91.9				
2 1/2	2.875	7	0.88	4.12	4	0.75	5.5	3.94
	73	177.8	22.4	104.6				
3	3.5	7.5	0.94	5	4	0.75	6	4.93
	88.9	190.5	23.9	127				
3 1/2	4	8.5	0.94	5.5	8	0.75	7	6.17
	101.6	215.9	23.9	139.7				
4	4.5	9	0.94	6.19	8	0.75	7.5	7
	114.3	228.6	23.9	157.2				
5	5.563	10	0.94	7.31	8	0.88	8.5	8.63
	141.3	254	23.9	185.7				
6	6.625	11	1	8.5	8	0.88	9.5	11.3
	168.3	279.4	25.4	215.9				
8	8.625	13.5	1.12	10.62	8	0.88	11.75	19.6
	219.1	342.9	28.4	269.7				

ANSI THREADED FLANGES

Nominal Pipe Size	Outside Diameter mm	Overall Diameter mm	Flange Thickness Min	Face Diameter mm	Number of Holes	Bolt Hole Diameter	Diameter of Circle Holes	Weight Kg/piece
10	10.75	16	1.19	12.75	12	1	14.25	28.8
	273	406.4	30.2	323.9				
12	12.75	19	1.25	15	12	1	17	43.2
	323.8	482.6	31.75	381				
14	14	21	1.38	16.25	12	1.12	18.75	58.1
	355.6	533.4	35.1	412.8				
16	16	23.5	1.44	18.5	16	1.12	21.25	76
	406.4	596.9	36.6	469.9				
18	18	25	1.56	21	16	1.25	22.75	93.7
	457.2	635	39.6	533.4				
20	20	27.5	1.69	23	20	1.25	25	122
	508	698.5	42.9	584.2				
24	24	32	1.88	27.25	20	1.38	29.5	185
	609.6	812.8	47.8	692.2				

